



# OptionAll™ Cleaning Pigs

Sizes: 4- through 14-inch



T.D. Williamson, Inc.

Bulletin No: 3030.003.04

Date: January 2007

Cross Indexing No: n/a

Supersedes: 3030.003.03 (2/06)



■ OptionAll™ Cleaning Pigs

## Description

TDW's OptionAll™ Cleaning Pigs can be assembled into several configurations. TDW has assembled four standard configurations to meet most applications.

Due to the unique design of the OptionAll Pig, customization is quickly accomplished with simple hand tools to achieve the best option for your pigging application. With the OptionAll Pig, you truly have an option.

## Features

The OptionAll Cleaning Pig features TDW's Formula SI polyurethane which is designed to provide superior abrasion resistance. This new polyurethane means more miles and more runs at less cost.

- Non-wearing components are constructed of Ultra High Molecular Weight (UHMW) polyethylene to protect internal pipe and valve surfaces.

- Recessed steel bolt and locknut construction is designed to prevent breakup of the pig in the pipeline.
- Low-cost, long-wearing design provides users with the option to dispose of or rebuild the pig.
- Large-diameter conical cups are designed to seal in the thinnest of pipe walls.
- Lightweight design can be handled by one person and reduces shipping costs.
- All OptionAll Pigs are supplied with large eye rings, which are designed to allow the pig to be easily hooked and removed from the receiving trap.

## Options

T.D. Williamson, Inc., is committed to providing you with the exact product to assist you in meeting the needs of your individual applications.

The OptionAll Cleaning Pig is designed to fit many needs, using standard TDW components. Special configurations can be made to meet virtually any customer specification. Some of the possible special configurations are listed below:

- Pigs can be made shorter or longer.
- Pigs can have more or fewer cups and/or discs in any arrangement.
- Pig bodies can be provided with cavities to house transmitters for tracking or locating purposes.
- Pigs cups and/or discs can be provided with bypass holes for maximum cleaning effectiveness.
- Cups and/or discs can be modified for very heavy wall pipe.
- Aluminum, slotted aluminum or steel gauging flanges can be provided.
- Brushes with stainless steel bristles.
- Pig cups and/or discs can be provided in Neoprene, Buna-N or Viton.

# OptionAll™ Cleaning Pigs

## 2C-1BR Configuration

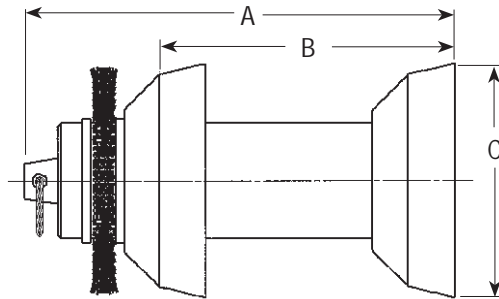

Size	Weight	Part Number	A	B	C
Inch (mm)	Lbs (kg)		Inch (mm)	Inch (mm)	Inch (mm)
4 (100)	3.0 (1.3)	02-2589-0004	7.75 (197)	5.0 (127)	4.50 (114)
6 (150)	7.5 (3.4)	02-2589-0006	12.12 (308)	8.31 (211)	6.62 (168)
8 (200)	13.5 (6.1)	02-2589-0008	15.38 (390)	10.78 (274)	8.62 (219)
10 (250)	26.0 (11.8)	02-2589-0010	20.69 (525)	15.78 (401)	10.6 (270)
12 (300)	32.0 (14.5)	02-2589-0012	22.12 (562)	15.98 (406)	12.6 (321)
14 (350)	36.50 (16.5)	02-2589-0014	22.81 (579)	16.12 (409)	14.0 (356)

2C-1BR Configurations are designed to traverse 1.5 DR bends.

## 4C-2BR Configuration

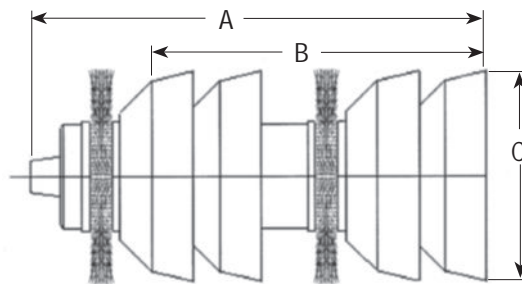

Size	Weight	Part Number	A	B	C
Inch (mm)	Lbs (kg)		Inch (mm)	Inch (mm)	Inch (mm)
4 (100)	2.75 (1.2)	02-2641-0004	10.75 (273)	8.00 (203)	4.50 (114)
6 (150)	10.39 (4.7)	02-2641-0006	14.31 (363)	10.5 (267)	6.62 (168)
8 (200)	19.73 (9.0)	02-2641-0008	20.68 (525)	16.09 (409)	8.62 (219)
10 (250)	36.72 (16.7)	02-2641-0010	23.00 (584)	18.09 (459)	10.62 (270)
12 (300)	49.50 (22.5)	02-2641-0012	28.44 (722)	22.28 (566)	12.62 (321)
14 (350)	56.63 (25.7)	02-2641-0014	29.12 (740)	22.43 (570)	14.00 (356)

4C-2BR Configurations are designed to traverse 3.0 DR bends.

# OptionAll™ Cleaning Pigs



## DCDC-2BR Configuration

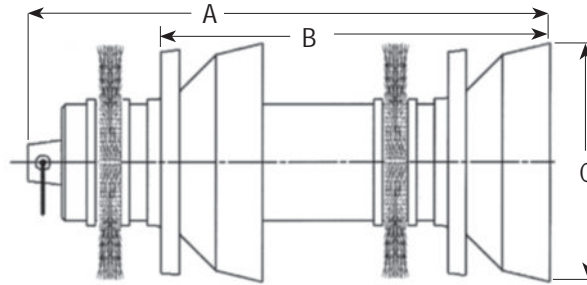

Size	Weight		A	B	C
Inch (mm)	Lbs (kg)	Part Number	Inch (mm)	Inch (mm)	Inch (mm)
4 (100)	2.75 (1.2)	02-2592-0004	8.50 (216)	6.00 (152)	4.50 (114)
6 (150)	10.39 (4.7)	02-2592-0006	14.44 (367)	10.75 (273)	6.62 (168)
8 (200)	19.73 (9.0)	02-2592-0008	19.56 (497)	15.62 (397)	8.62 (219)
10 (250)	36.72 (16.7)	02-2592-0010	21.38 (543)	17.31 (490)	10.62 (270)
12 (300)	49.50 (22.5)	02-2592-0012	26.56 (675)	22.25 (565)	12.62 (321)
14 (350)	56.63 (25.7)	02-2592-0014	27.25 (692)	22.94 (583)	14.00 (356)

DCDC-2BR Configurations are designed to traverse 3.0 DR bends.

## 4D-2BR Configuration

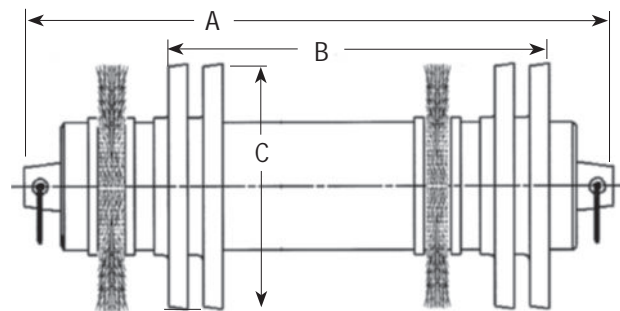

Size	Weight		A	B	C
Inch (mm)	Lbs (kg)	Part Number	Inch (mm)	Inch (mm)	Inch (mm)
4 (100)	2.75 (1.3)	02-2591-0004	10.25 (260)	6.50 (165)	4.31 (109)
6 (150)	9.75 (4.4)	02-2591-0006	15.00 (381)	9.68 (246)	6.25 (159)
8 (200)	17.83 (8.1)	02-2591-0008	19.62 (498)	14.06 (357)	8.38 (213)
10 (250)	34.21 (15.5)	02-2591-0010	21.38 (543)	15.56 (395)	10.50 (267)
12 (300)	40.80 (18.5)	02-2591-0012	25.38 (644)	19.31 (490)	12.50 (318)
14 (350)	47.75 (21.7)	02-2591-0014	25.38 (644)	19.31 (490)	13.75 (349)

4D-2BR Configurations are designed to traverse 3.0 DR bends.

# OptionAll™ Cleaning Pigs

## Replacement Cups, Discs and Brushes

Size Inch (mm)	Cup Weight Lbs (kg)	Cup Part Number	Disc Weight Lbs (kg)	Disc Part Number	Brush Weight Lbs (kg)	Brush Part Number
4 (100)	0.4 (0.2)	00-4120-0004-03	0.2 (0.1)	00-1702-0014-00	0.5 (0.25)	02-2605-0004-00
6 (150)	1.2 (0.5)	00-4120-0006-03	0.8 (0.4)	00-1702-0001-00	0.5 (0.25)	00-7078-0006-00
8 (200)	2.5 (1.1)	00-4120-0008-03	1.5 (0.7)	00-1702-0002-00	1.0 (0.5)	00-7078-0008-00
10 (250)	3.7 (1.7)	00-4120-0010-03	2.4 (1.1)	00-1702-0003-00	2.0 (1.0)	00-7078-0010-00
12 (300)	6.0 (2.7)	00-4120-0012-03	3.4 (1.5)	00-1702-0004-00	3.0 (1.5)	00-7078-0012-00
14 (350)	8.0 (3.6)	00-4120-0014-03	4.0 (1.8)	00-1702-0010-00	3.75 (1.7)	00-7078-0014-00

## Bypass Hole Recommendations\*

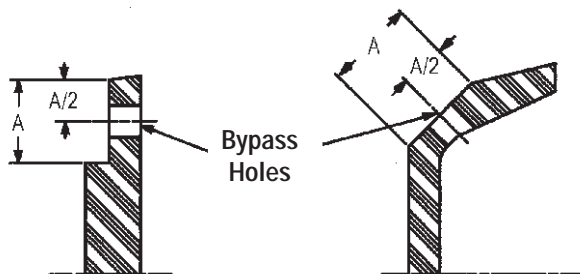

Size		No. of Eql Sp Holes	Diameter of Holes	
Inch	mm		Inch	mm
4"	100	4	.37"	10
6"	150	6	.50"	13
8"	200	8	.50"	13
10"	250	8	.63"	16
12"	300	8	.75"	19
14"	350	8	.75"	19

\* for approximately 3% bypass

Cups and discs with bypass holes are available from the factory.

Wood boring bits are recommended for drilling holes in urethane.